



*fluid under control*



**SANITARY ACTUATOR  
TORK HRA SERIES**

## PRODUCT DESCRIPTION

**Sanitary valve:** Sanitary valve is a valve for use in stainless steel pipe systems. There are varieties stainless steel butterfly valves and stainless steel ball valves.

**Hygienic actuator:** TORQUE HRA hygienic stainless steel actuators are used usually in the food and chemical industry for stainless steel butterfly valves and stainless steel ball valve control.

## WORK PRINCIPLE

The actuator is made in three Standard versions, normally closed (NC) normally open (NO), and air/air activated. The actuator is designed so that an axial movement of a piston is transformed into a 90° rotation of a shaft. The torque of the actuator is increased when the valve disc contacts the seal ring of the butterfly valve.

## APPLICATION

Brackets provide connection butterfly valve with sanitary actuator.  
Valve position indicators and limit switch box connect.  
Actuator type is selected by butterfly valve diameter and torque.  
Butterfly valve: source connection, flange connection, welding connection can be.

## DESIGN

Butterfly valve is available three versions: for ISO tubes, for DIN tubes ve for flange connection. The valve consists of two valve body halves, valve disc, bushes for the disc stem and seal ring. Flange valve also consists of two flanges and two flange seal rings. The valve is assembled by means of screws and nuts. Two actuators sizes, 85 mm and 133 mm, cover all valve sizes. The actuator is available in two versions, TORK-HRA.85 TORK-HRA.133. The actuator is fitted onto the valve by means of bracket and screw.(The actuator can also be fitted onto ball valves by means of special brackets).

## TECHNICAL DATA



Actuator Order No:	TORK-HRA.85
Actuator Order No :	TORK-HRA.133
Max. Air Pressure:	700 kPa (7 bar)
Min. Air Pressure NC ve NO	400 kPa (4 bar)
Temperature Range:	-25 C / +90 C
Air Consumption (litres-free air) - Ø133 mm:	0.95 x p (bar)
Air Consumption (litres-free air) - Ø85 mm:	0.24 x p (bar)
Actuator Body:	Stainless steel AISI 304
Piston:	Light alloy (for 85 mm: bronze)
Seal:	Nitril (NBR)
Housing For Switches:	Noryl (PPO)
Weight:	TORK-HRA 133...13 kg
Weight:	TORK-HRA 85...3 kg



Order No	Valve Dimensions (mm)
TORK-HRA.85	NW 25, 32, 40, 50, 65, 80
TORK-HRA.133	NW 100, 125, 150

## DIMENSIONS(mm) - ACTUATOR

### Actuator With Coupling

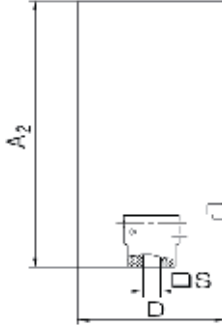

SIZE		Function	DIMENSIONS (mm)		
mm	DIN		A2	D	s
25-63.5	25-50	NC	185	85	8
76.1	65-80	NC	183	85	10
101.6	100	NC	183	85	12
101.6	100	NC	308	133	12
	125	NC	308	133	14
152	150	NC	308	133	15
25-63.5	25-50	NO	185	85	8
76.1	65-80	NO	183	85	10
101.6	100	NO	183	85	12
101.6	100	NO	308	133	12
	125	NO	308	133	14
152	150	NO	308	133	15
25-63.5	25-50	A/A	185	85	8
76.1	65-80	A/A	183	85	10
101.6	100	A/A	183	85	12
	125	A/A	187	85	14
152	150	A/A	187	85	15
101.6	100	A/A	308	133	12
	125	A/A	308	133	14
152	150	A/A	308	133	15

**NO:** Normally Open

**H/H:** Air-Air

**NC:** Normally closed

## MOUNTING BRACKETS FOR SANITARY ACTUATOR

Brackets provide connection butterfly valve with sanitary actuator



## MOUNTING BRACKETS FOR TORK-HRA.85 ACTUATOR

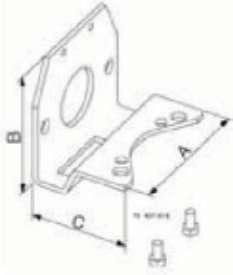

INCH	DIN	A	B	C
25-63.5	25-50	85	75.5	58.5
	65	85	75.5	58.5
76.1-101.6	80-100	125	77.5	70.0
	125	125	88.0	75.0
152	150	125	88.0	69.2

## MOUNTING BRACKETS FOR TORK-HRA.133 ACTUATOR

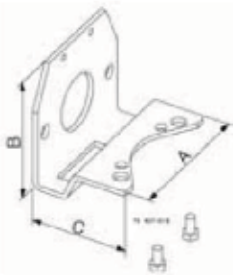

INCH	DIN	A	B	C
101,6	100-125	130	120	91,8
152	150	130	120	92

## ISO 2037 BUTTERFLYVALVE BODIES WELDED ENDS

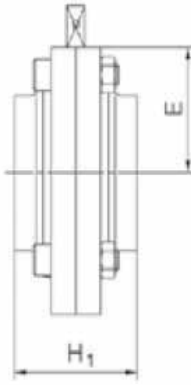

Size ISO DN/OD	Dimensions(mm)	
	E	H1
25	32.5	47
38	32.5	47
51	42	52
63.5	52	54
76.1	57	62
101.6	77	80
152	104	80

### MATERIAL

**Valve Body:** 1.4307(304L) - 1.4404(316L)

**Seal:** EPDM, SILICONE, FPM, HNBR, PFA

## DIN BUTTERFLY VALVE BODY WELDED ENDS

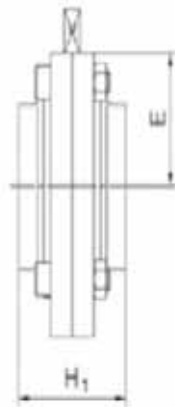

Size DIN/DN	Dimensions(mm)	
	E	H1
25	33,3	47
32	33,3	47
40	37,7	47
50	46,6	52
65	57,3	62
80	63,0	64
100	77,0	80
125	96,7	110
150	104,0	80

### MATERIAL

**Valve Body:** 1.4307(304L) - 1.4404(316L)

**Seal:** EPDM, SILICONE, FPM, HNBR, PFA



*all over the world*

YENİKÖY 212 217 6885/HA.BİG.01.2015

#### AFRICA

ALGERIA  
EGYPT  
ETHIOPIA  
IVORY COAST  
KENYA  
MOROCCO  
NIGERIA  
SOUTH AFRICA  
TUNISIA

#### AMERICA

ARGENTINA  
DOMINICAN REPUBLIC  
CANADA  
CHILE  
COLOMBIA  
PERU  
UNITED STATES OF AMERICA

#### ASIA

AZERBAIJAN  
INDIA  
INDONESIA  
IRAQ  
IRAN  
ISRAEL  
KAZAKHSTAN  
KUWAIT  
LEBANON  
MALAYSIA  
OMAN  
PAKISTAN  
SAUDI ARABIA  
SINGAPORE  
SOUTH KOREA  
SRI LANKA  
SYRIA  
THAILAND  
TURKISH REP. OF N. CYPRUS  
UNITED ARAB EMIRATES  
UZBEKISTAN  
VIETNAM

#### EUROPE

ALBANIA  
AUSTRIA  
BELGIUM  
BULGARIA  
CROATIA  
CZECH REPUBLIC  
DENMARK  
ESTONIA  
FRANCE  
GERMANY  
GORGIA  
GREECE  
IRELAND  
ITALY  
KOSOVO  
LATVIA  
LITHUANIA  
LUXEMBOURG  
MALTA  
MOLDOVA  
NETHERLANDS  
NORWAY  
ROMANIA  
RUSSIA  
SERBIA  
SPAIN  
SWEDEN  
UKRAINE  
UNITED KINGDOM

#### AUSTRALIA

AUSTRALIA  
NEW ZEALAND



#### SMS Sanayi Malzemeleri Üretim ve Satış A.Ş.

H. Office: Y. Dudullu, Bostancı Yolu Kuru Sk. No:16, 34776 Ümraniye - İstanbul - Turkey Phone : +90 216 364 34 05 (pbx) Fax : +90 216 364 37 57

Plant: İMES O.S.B., 5. Cad. No:6 Çerkeşli OSB Mahallesi - Dilovası Kocaeli - Turkey Phone : +90 262 290 20 20 Fax : +90 262 290 20 21

export@sms-tork.com.tr www.smstork.com